



W. Schmid AG

LED-Technology
the visible difference

LED spot SPL75



SPL75, 12 VDC

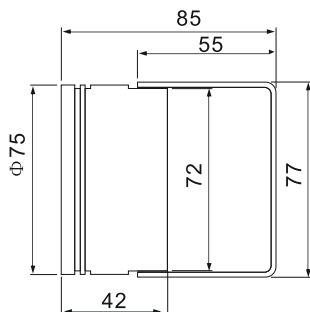

2 mounting holes Ø 5mm,
distance: 20mm

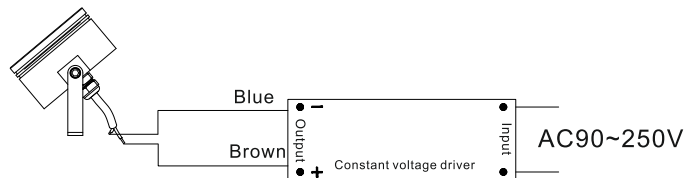
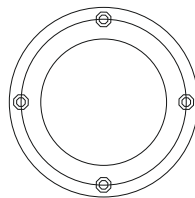

Wiring diagram

Specifications:

Description:	LED spot light type SPL75, 75mm
Dimensions:	Ø 75mm, L=44mm
Supply voltage:	12 VDC
Power consumption:	3W
Viewing angles:	15°/45°/60°
Degree of protection:	IP 65
Class of protection:	III
Operating temperature:	-25 up to +50°C
Material:	Colourless anodized aluminium, transparent PC lens
Weight:	0.375kg
Connection:	Cable, length: 0.30-0.40m
Available ill. colours:	white, warm white, red, yellow, green, blue, orange, RGB
Applications:	Machine light, working place light, signalling device, decorative lamp, garden lamp etc.