



W. Schmid AG

LED-Technology
the visible difference

LED-ill. Push Buttons LDT 40



LDT 40 - LED-ill. Push Button 5/12/24/36/48 VDC

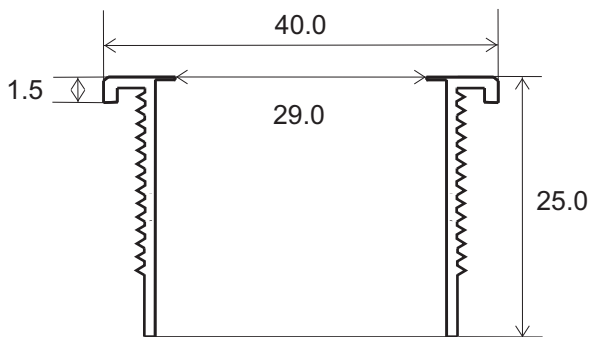

Nut M35x1 / AF 38mm
O-ring 1.6mm

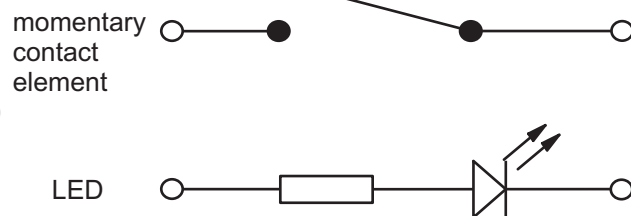

Contact element max. 32 VDC / 50mA
LED for 5/12/24/36/48 VDC

- 35mm mounting hole
- 29mm colored or white opaque epoxy lens
- colorless or black hard anodized aluminum housing
- splash-proof push-button mechanism and connection side encapsulation
- vandal proof and acid resistant
- shock- and vibration resistant
- long life-time >50'000 hours for the LED, >500'000 operations for the switch
- LED-variants from 5 VDC to 48 VDC using momentary switch max. 32 VDC/50mA
- faston-, cable- or screw connections available
- lettering on illuminated surface possible
- for use in the chemical industry, machine building, railways, mining or access control

Technical specifications

Luminosity, wavelength

red	65mcd	645nm
yellow	70mcd	583nm
green	50mcd	575nm
orange	14mcd	640nm
blue	60mcd	470nm
red-green	65/50mcd	645/575nm
red-green-blue	65/50/60mcd	645/575/470nm

Current consumption

5/12/24/48/72/115 VDC	20-40 mA
115/230/380 VAC	2-8mA

Operating and storage temperature

-40°C up to +85°C

Standard options

Series

SL = flat LED signal lamp
LDT = flat LED ill. push button
WSF = LED signal lamp convex

Diameter

25/30/40/60 = 25/30/40/60mm

Terminals

F = faston terminals 2,8 x 0,8mm
S = screw connections
C = cable connection 1,2m

Color code

1 = red 4 = orange 8 = red-green
2 = yellow 6 = blue 136 = red-green-blue
3 = green 7 = white

Lens

C = colored
W = white opaque

Voltages

5/12/24/48/72/115 VDC
115/230/380 VAC

Housing

A = standard aluminum housing, colorless, hard anodized
B = aluminium, black anodized
N = nickel plated aluminum
C = chrome plated aluminum

Nut

M = metal nut (nickel plated brass), standard

Ordering example

LDT40 F2 W24 DAP



LED ill. push-button LDT 40, 40mm diameter, faston terminals 2,8 x 0,8mm, yellow LED, white lens, 24 VDC, hard anodized colorless aluminum housing, N/O contact element 32VDC/50mA, metal fixing nut M35x1, O-ring 1,6 mm

Upon request

- other voltages
- common anode
- other connections
- flashing LED
- other housing colors
- lettering on illuminated surface

Manufacturer

W. Schmid AG
Dorfstrasse 23
5442 Fislisbach
Switzerland
Tel: +41 56 470 00 77 Fax: +41 56 470 00 74
E-mail: sales@led-lamps.ch URL: <http://www.led-lamps.ch>